



REQUEST FOR PROPOSAL (RFP)

SALISH DRIVE 10-UNITS HOUSING – SANITARY SEWER SCOPE

TLA'AMIN NATION
4779 KLAHANIE ROAD, POWELL RIVER, BC, V8A 0C4

ISSUE DATE: MARCH 29, 2022.

TABLE OF CONTENTS

1.	INFORMATION FOR APPLICANTS	4
a.	Summary	4
b.	Community & Project Background	4
2.	REQUEST FOR CONTRACTOR	5
a.	Nature of Services Required	5
3.	SUBMISSION INFORMATION	5
4.	EVALUATION	5
a.	Criteria	6
b.	Submission Deadline	6
5.	TERM.....	6
6.	REFERENCES.....	6
7.	INQUIRIES	6
	APPENDIX A: DESIGN DRAWINGS	7

REQUEST FOR PROPOSAL (RFP)

NO: 940-SanSew

COVER PAGE

Issue Date:
March 29, 2022
Closing Date:
April 12, 2022

Company Name: _____
Contact Person Name: _____
Address: _____
City: _____
Prov: _____ Postal: _____
Email: _____
Phone: _____
Fax: _____

GUIDELINES FOR PROPOSAL DELIVERY

An electronic copy of your proposal must be delivered by email to:

publicworks@tn-bc.ca

Attention: Public Works, Tla’amin Nation

Email attachments should be clearly marked with the name of the applicant.

1. INFORMATION FOR APPLICANTS

a. Summary

Tla'amin Nation (TN) is seeking proposals from civil contractors to construct a sanitary sewer system at our Salish Drive 10-Units Housing project. TN will provide an engineered design of the sanitary system. Please submit proposals that include your cost estimate, company experience, and scheduling availability.

b. Community & Project Background

Tla'amin is a modern treaty Nation as of April 2016. This means Tla'amin Lands are owned by the Nation in restricted fee simple, and the Nation has law-making authority with respect to management, planning, zoning and development on Tla'amin Lands. You will work collaboratively with Tla'amin staff to ensure your work meets Tla'amin development laws.

Our community is currently facing a significant housing shortage. This project will create 10 new social housing units to address this issue and work towards closing the socio-economic gap that our community members face. The project consists of 5 duplex homes, 10 housing units in total. Please see detailed drawings attached to this RFP for more details.

For more information on the TN, refer to our website: www.tlaaminnation.com.

2. REQUEST FOR CONTRACTOR

a. Nature of Services Required

The Tla'amin Nation is seeking proposals from contractors to construct a sanitary sewer system at our Salish Drive 10-Units Housing project. The new infrastructure will need to connect into the existing sanitary system. The civil design can be found in Appendix A: Design Drawings.

The scope of work will include the following:

- Coordination with Tla'amin Nation's project team to confirm roles and responsibilities.
- Coordinate with Civil Engineer during site inspections, record drawing preparation, and if any errors or discrepancies are found in the design.
- Provide and install five (5) X 4" sanitary service pipe to each new home as per drawings.
- Provide and install 6" sewer line from new home service pipes to pump tank as per drawings.
- Provide and install trash/pump chamber (FRP10000-8H or equivalent) as per drawings.
- Provide and install 2" pressure sewer line from trash/pump tank to existing manhole as per drawings.

3. SUBMISSION INFORMATION

Applicants are requested to submit a proposal with the following information:

- Description of proposed approach for the scope of works;
- Company experience with similar work;
- Costs for all items identified in Section 2a;
- Proposed schedule of deliverables to completion;
- A description of the basis, timing and terms of proposed billings;
- General liability amount (\$) of insurance carried by the company to be identified; and
- Work Safe BC clearance letter prior to work being awarded.

4. EVALUATION

This section details all criteria against which proposals will be evaluated. **The Tla'amin Nation reserves the right to not select any proposal.**

Applicants should ensure they fully respond to all submission information outlined above and the criteria listed below to receive full consideration during evaluation.

a. **Criteria**

Proposals not clearly demonstrating that they meet the following criteria may be excluded from further consideration during the evaluation process. Proposals for this RFP which meet all criteria will be evaluated as follows:

Proposals meeting the minimum criteria will be evaluated as follows:	Weight
Understanding of the requirements and completeness of proposal	5%
Qualifications and experience, including references	20%
Overall project approach and timeline	20%
Budget estimates	55%
Total	100%

b. **Submission Deadline**

All questions must be submitted to Public Works (publicworks@tn-bc.ca) before 5:00pm on April 5th 2022.

Complete proposals must be submitted electronically by 5:00pm on April 12th 2022.

5. **TERM**

The successful contractor will be notified by April 14, 2022. The term of the contract will be determined by your project schedule completion date.

6. **REFERENCES**

Tla’amin Nation will conduct reference checks after the proposal is submitted. Tla’amin Nation will not enter a contract with any applicant whose references, in the opinion of Tla’amin Nation, do not confirm the information provided in the RFP.

7. **INQUIRIES**

All inquiries regarding the services of the anticipated contract or the administrative details of the RFP are to be directed to:

Public Works, Tla’amin Nation
publicworks@tn-bc.ca

TLA'AMIN NATION, POWELL RIVER, BC

PART LOT 13 AND LOT 20,
DL 8218, PLAN EPP58243

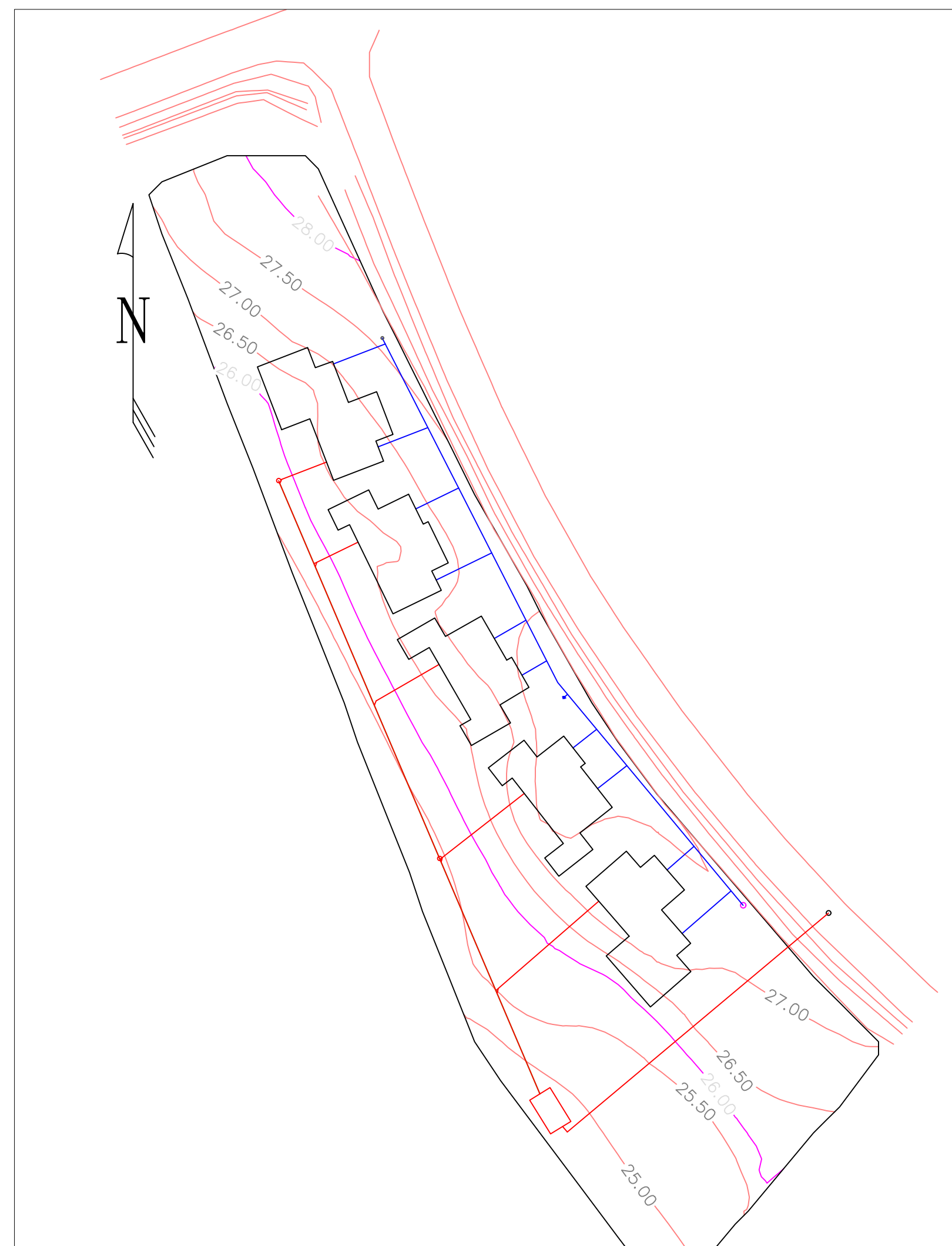

SITE PLAN

List of Drawings:

- P210422-201 SITE PLAN
- P210422-202 WATER PLAN+PROFILE
- P210422-203 SEWER PLAN+PROFILE
- P210422-204 WATER DETAILS
- P210422-205 SEWER DETAILS
- P210422-206 STORM PLAN
- P210422-207 STORM PROFILE
- P210422-208 TANK DESIGN



LOCATION

Survey by:

POLARIS LAND SURVEY INC.

7045 Field St #3.
Powell River, BC

Designed and Prepared by:

PSA Engineering

4740 Joyce Ave.
Powell River, BC
V8A 3B6
604-485-0205
mcginn.sean@gmail.com

Developer:

Tla'amin Nation

Craig Galligos
4779 Klahanie Dr,
Powell River, BC
V8A 0C4

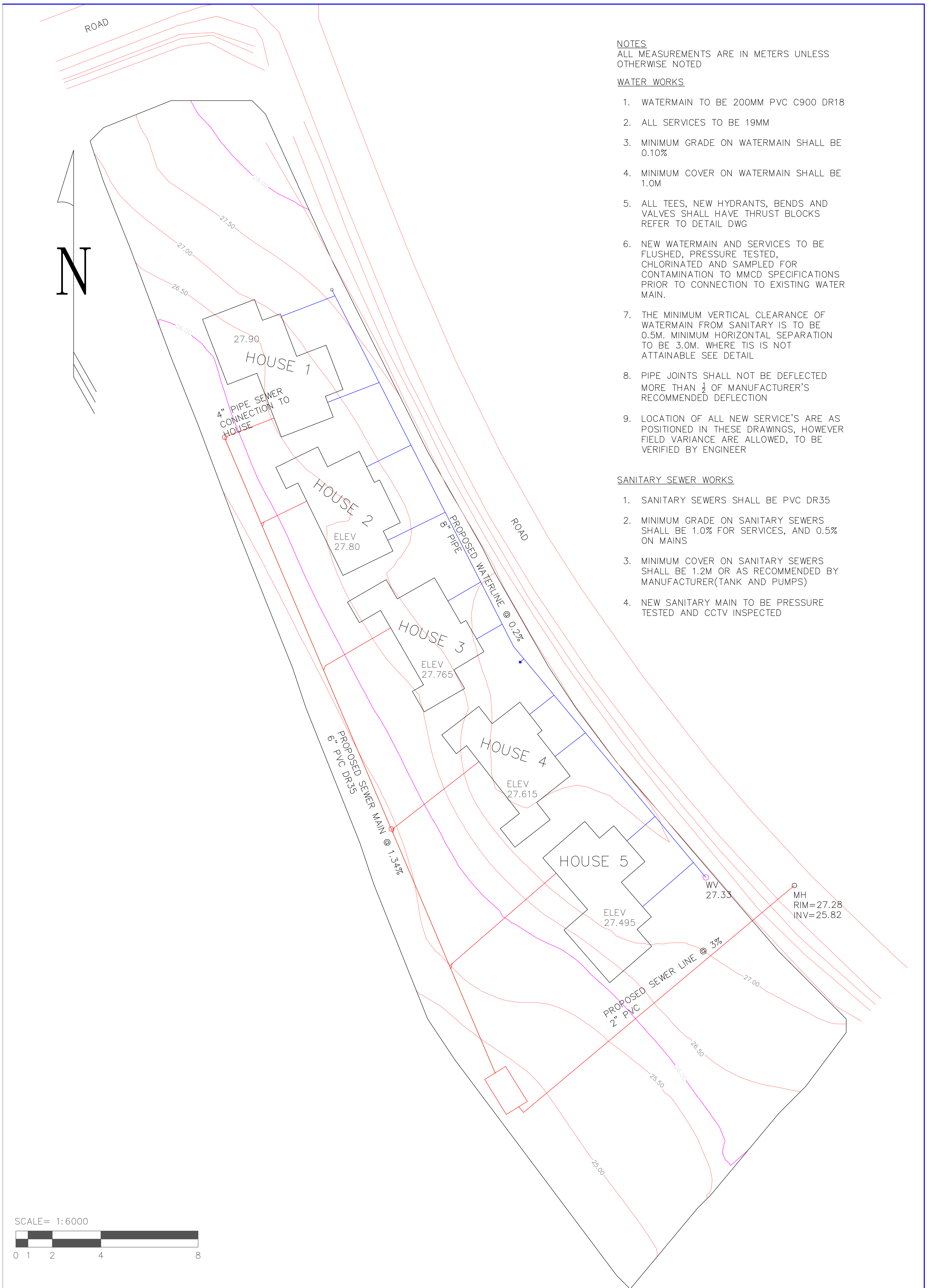

NOTES
 ALL MEASUREMENTS ARE IN METERS UNLESS OTHERWISE NOTED

- WATER WORKS**
1. WATERMAIN TO BE 200MM PVC C900 DR18
 2. ALL SERVICES TO BE 19MM
 3. MINIMUM GRADE ON WATERMAIN SHALL BE 0.10%
 4. MINIMUM COVER ON WATERMAIN SHALL BE 1.0M
 5. ALL TEES, NEW HYDRANTS, BENDS AND VALVES SHALL HAVE THRUST BLOCKS REFER TO DETAIL DWG
 6. NEW WATERMAIN AND SERVICES TO BE FLUSHED, PRESSURE TESTED, CHLORINATED AND SAMPLED FOR CONTAMINATION TO MMCD SPECIFICATIONS PRIOR TO CONNECTION TO EXISTING WATER MAIN.
 7. THE MINIMUM VERTICAL CLEARANCE OF WATERMAIN FROM SANITARY IS TO BE 0.5M. MINIMUM HORIZONTAL SEPARATION TO BE 3.0M. WHERE THIS IS NOT ATTAINABLE SEE DETAIL
 8. PIPE JOINTS SHALL NOT BE DEFLECTED MORE THAN 1/3 OF MANUFACTURER'S RECOMMENDED DEFLECTION
 9. LOCATION OF ALL NEW SERVICES ARE AS POSITIONED IN THESE DRAWINGS, HOWEVER FIELD VARIANCE ARE ALLOWED, TO BE VERIFIED BY ENGINEER

- SANITARY SEWER WORKS**
1. SANITARY SEWERS SHALL BE PVC DR35
 2. MINIMUM GRADE ON SANITARY SEWERS SHALL BE 1.0% FOR SERVICES, AND 0.5% ON MAINS
 3. MINIMUM COVER ON SANITARY SEWERS SHALL BE 1.2M OR AS RECOMMENDED BY MANUFACTURER(TANK AND PUMPS)
 4. NEW SANITARY MAIN TO BE PRESSURE TESTED AND CCTV INSPECTED

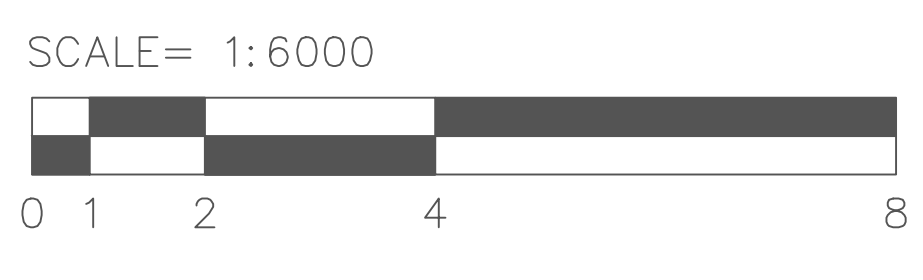

REV	Y	M	D	DESCRIPTION	DRN	DES	CHK	ENG
22	02	02			SC	SM	SM	SM

PSA ENGINEERING DIV. of
 ATEK SURVEYS LTD.
 4740 JOYCE AVE,
 POWELL RIVER,
 B.C. CAN. V8A 4B6
 PH: 604-485-0205
 FAX: 604-485-0200
 EMAIL: paulsteffens@psa-eng.com

TLA'AMIN NATION SALISH DUPLEXES		SITE PLAN PLAN VIEW		
SIZE	SCALE	DWG NO.	REV	SHEET
D	1:6000	P210422-201	C	1 of 8

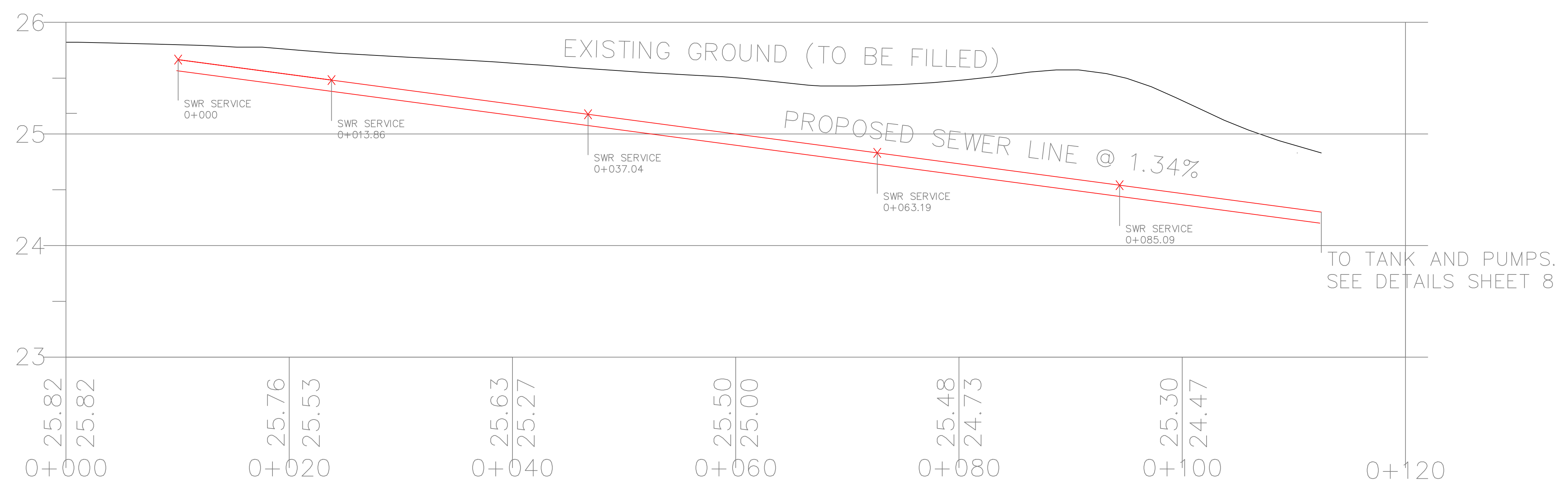
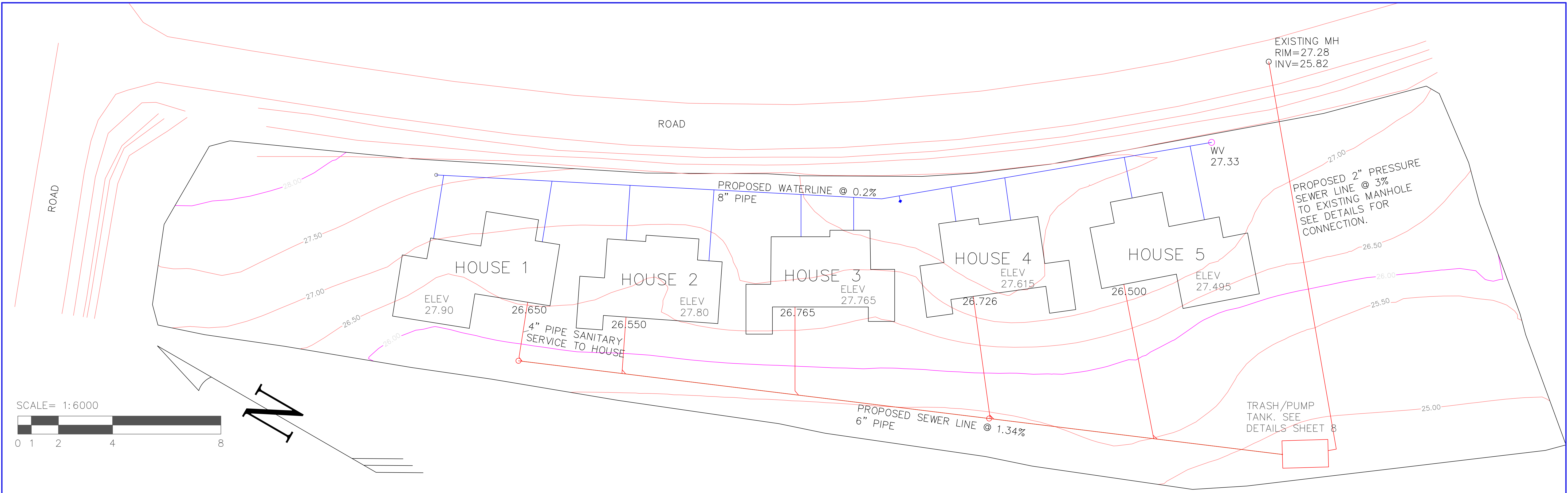

COMMENTS:

G					
F					
E					
D					
C					
B					
A	22	02	02		
REV	Y	M	D		

DESCRIPTION	DRN	DES	CHK	ENG
	SC	SM	SM	SM

PSA ENGINEERING DIV. of ATEK SURVEYS LTD.
 4740 JOYCE AVE,
 POWELL RIVER,
 B.C. CAN. V8A 4B6
 PH.: 604-485-0205
 FAX: 604-485-0200
 EMAIL: paulsteffens@psa-eng.com

TLA'AMIN NATION SALISH DUPLEXES
SEWER LINE PLAN/PROFILE VIEW

SIZE	SCALE	DWG. NO.	REV	SHEET
D	1:6000	P210422-202	C	3 of 8

- FRP10000-8H or Equivalent
- 7500 IG Trash Tank
- 2500 IG Pump Chamber
- 24" Manway
- Baffle Wall
- 4" Penetration Inlet / Vent
- 2" Penetration Outlet
- Pump Platform
- 2 - Ashland EP45MI-20 Effluent Pumps or Equivalent
- Rhombus Duplex Float Panel
- Signal Control Floats

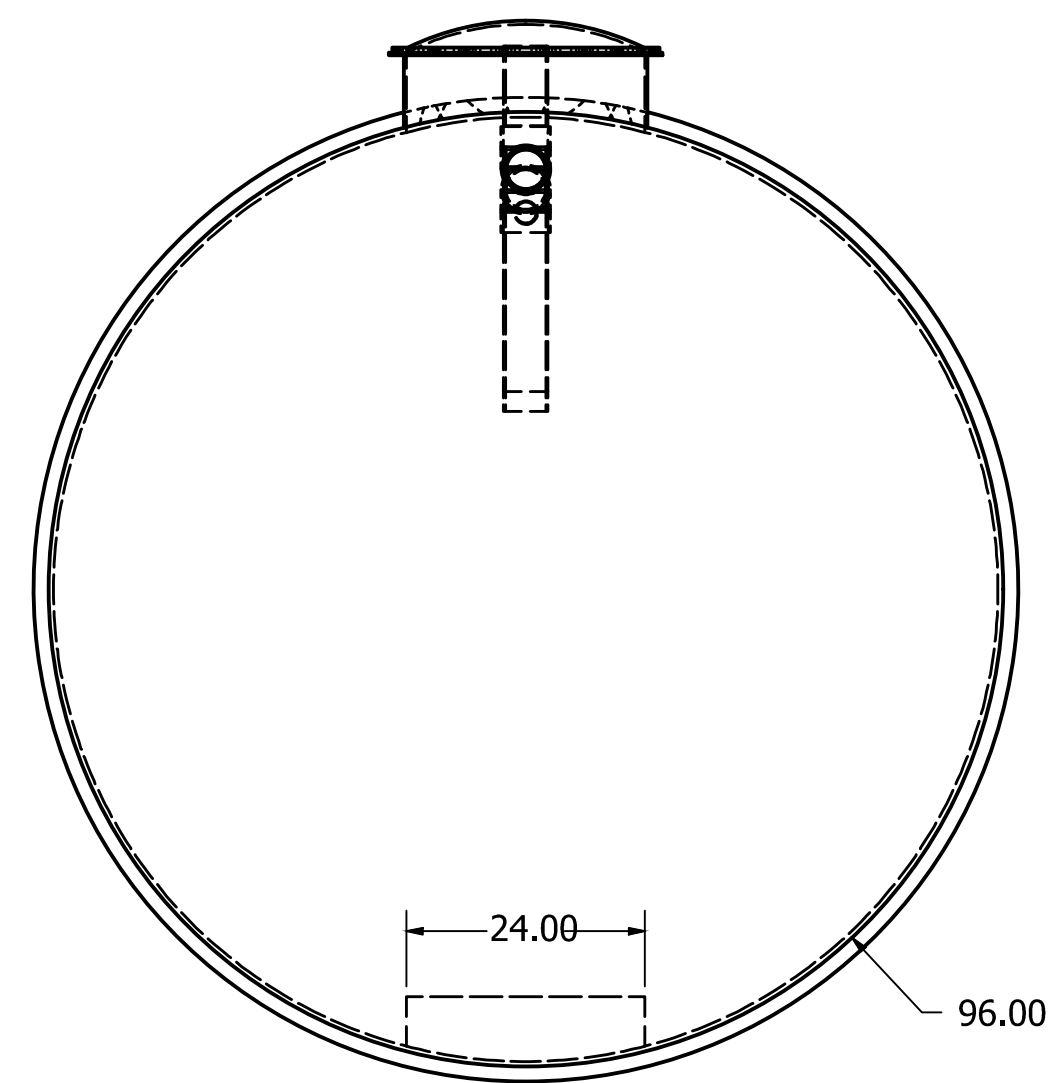
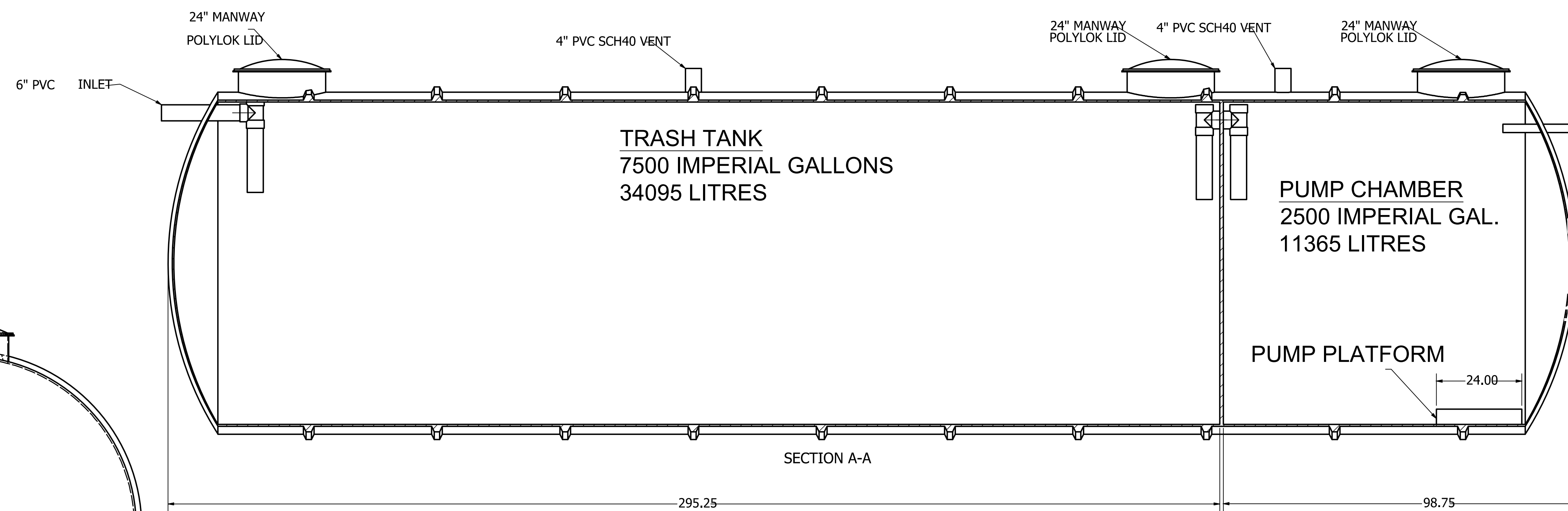
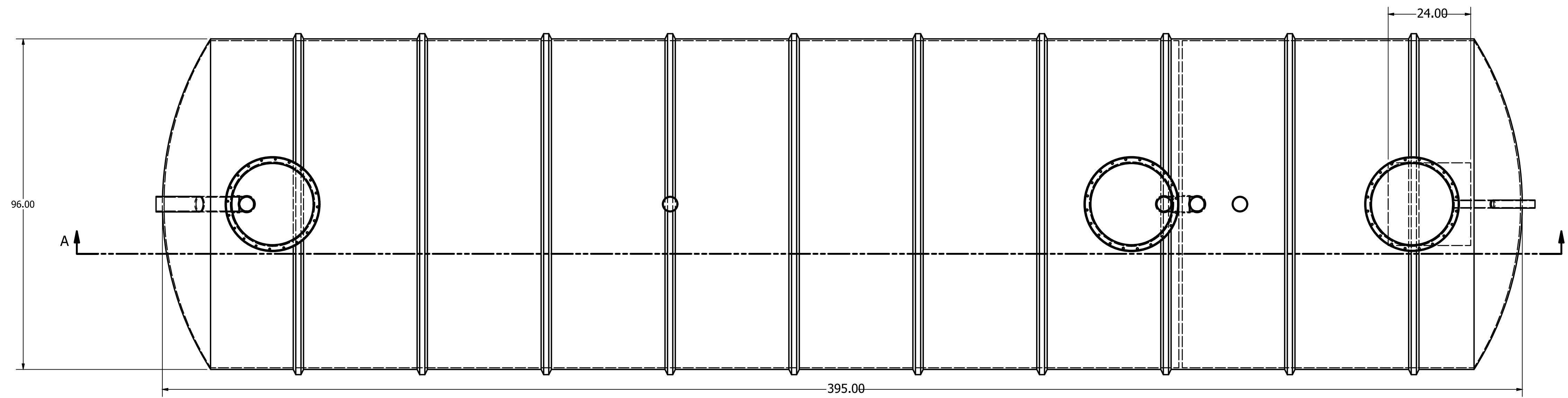

REV	Y	M	D	DESCRIPTION	SC	SM	SM	SM
A	22	02	02					

PSA ENGINEERING DIV. of
ATEK SURVEYS LTD.

4740 JOYCE AVE,
POWELL RIVER,
B.C. CAN. V8A 4B6
PH: 604-485-0205
FAX: 604-485-0200
EMAIL: paulsteffens@psa-eng.com

TLA'AMIN NATION SALISH DUPLEXES		TRASH/PUMP CHAMBER FRP10000-8H	
SIZE	SCALE	DWG NO.	REV
D	NTS	P210422-208	A
			SHEET
			6 of 8

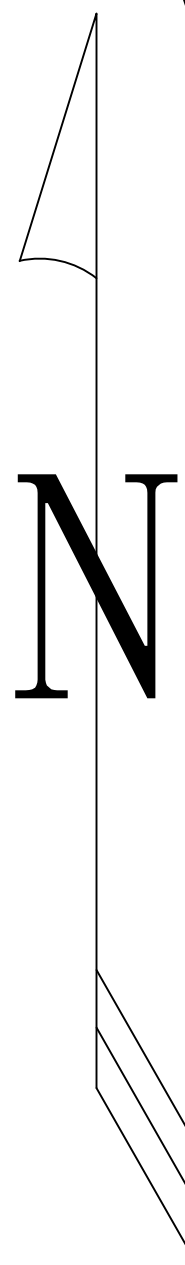

SCALE= 1:6000

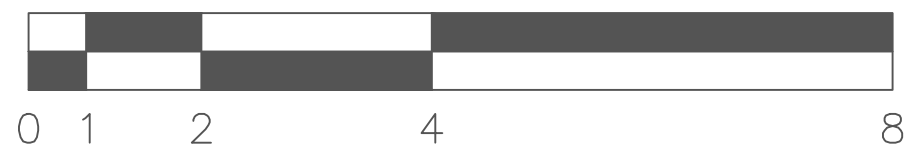

LEGEND

ROCK PIT
6' X 4' X 6'

WATER FLOW DIRECTION

STORM NOTES

1. STORM FLOW AWAY FROM STRUCTURES SHALL BE IN AN EASTERLY DIRECTION TOWARDS EXISTING SWALE ON FRONT/EAST SIDE. TO THE WEST ON BACK SIDE
2. STORM FLOW FROM STRUCTURES SHALL BE DISCHARGED TO A ROCK PIT. SEE STORM WATER MANAGEMENT REPORT AND DETAILS.
3. MINIMUM BUILDING ELEVATIONS FOR LOTS HAVE BEEN SET AND ARE TO BE CONSTRUCTED AS SHOWN. THE M.B.E. IS ESTABLISHED ABOVE THE 100 YEAR HYDRAULIC GRADE LINE.

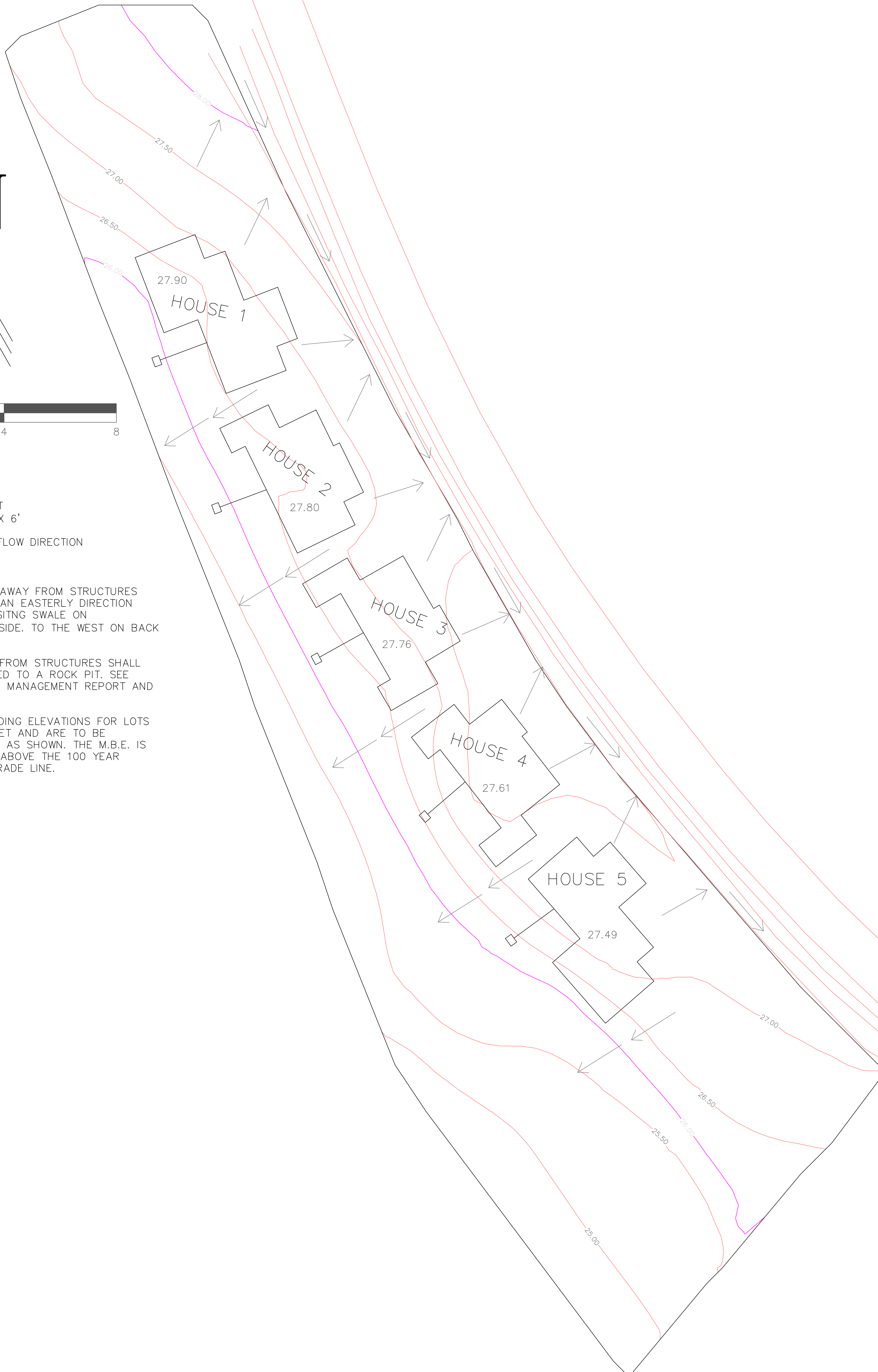

REV	Y	M	D	DESCRIPTION	DRN	DES	CHK	ENG
22	02			Roof water leaders are to be discharged to storm service connection	SC	SM	SM	SM

PSA ENGINEERING DIV. of ATEK SURVEYS LTD.
 4740 JOYCE AVE,
 POWELL RIVER,
 B.C. CAN. V8A 4B6
 PH: 604-485-0205
 FAX: 604-485-0200
 EMAIL: paulsteffens@psa-eng.com

**TLA'AMIN NATION
 SALISH DUPLEXES**
**STORM PLAN
 PLAN VIEW**

SIZE	SCALE	DWG NO.	REV	SHEET
D	1:6000	P210422-206	C	7 of 8

See Stormwater
Management Report

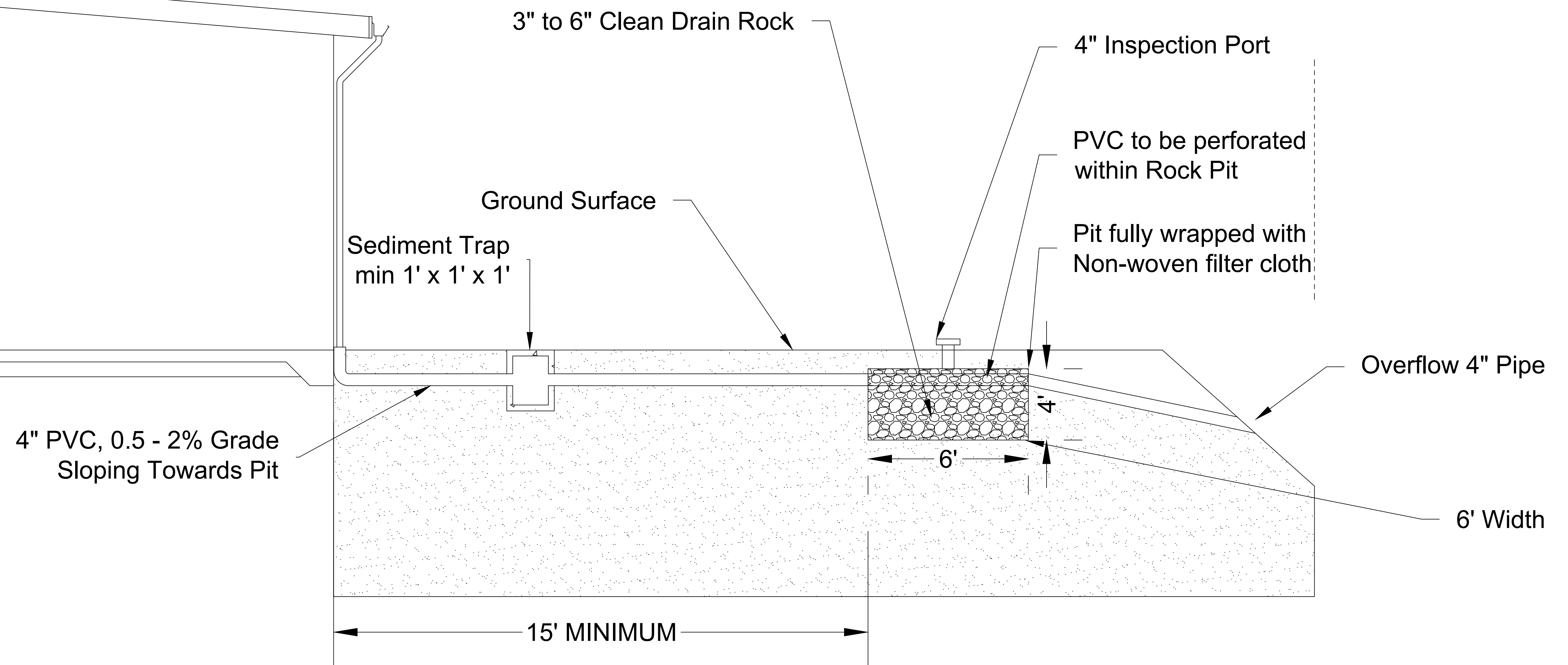

COMMENTS:

G											
F											
E											
D											
C											
B											
A	22	02	02					SC	SM	SM	SM
REV	Y	M	D					DRN	DES	CHK	ENG

PSA ENGINEERING DIV. of
ATEK SURVEYS LTD.
4740 JOYCE AVE,
POWELL RIVER,
B.C. CAN. V8A 4B6
PH: 604-485-0205
FAX: 604-485-0200
EMAIL: paulsteffens@psa-eng.com

TLA'AMIN NATION
SALISH DUPLEXES
ROCK PIT - TYPICAL
PROFILE

SIZE	SCALE	DWG. NO.	REV	SHEET
D	NTS	P210422-207	A	8 of 8